



Image depicts items not supplied by Metricon namely landscaping and fencing.

# LUXOR

**LOT: 2**

**LOT SIZE: 199m<sup>2</sup>**

**HOME SIZE: 220m<sup>2</sup>**

2  2.5  3 

The three-bedroom Luxor delivers you true family living in an effortlessly modern format. Its inviting entrance leads to a welcoming living area, as well as a spacious laundry, linen closet and powder room. A private courtyard out the back creates the indoor-outdoor scene, perfect for the entertainer. Upstairs you will discover three substantial bedrooms offering the perfect retreat for each family member.

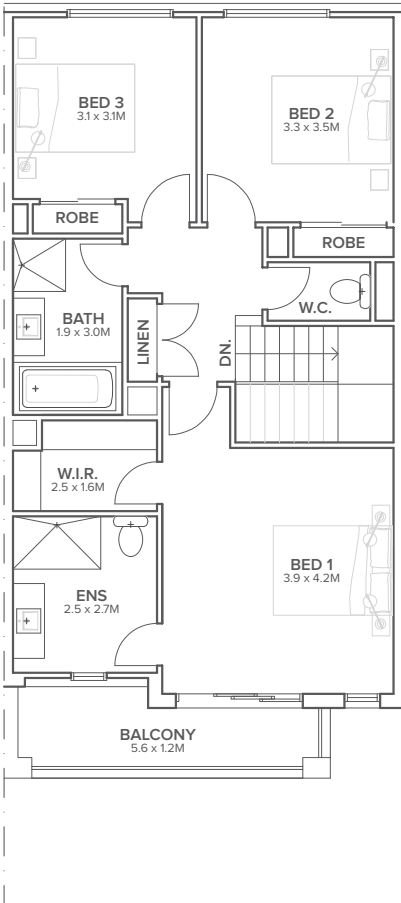
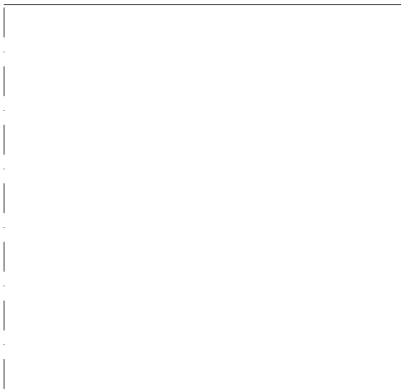
[illegible]

The site plan shows a rectangular area labeled "GARAGE" with dimensions "6.5 x 6.0M". Inside the garage, two cars are parked side-by-side. To the left of the garage is a curved wall and a small rectangular structure. To the right is a rectangular structure with a textured pattern. A driveway, represented by a series of small squares, leads from the bottom of the plan into the garage area. The entire area is enclosed by a thick black line representing a wall.

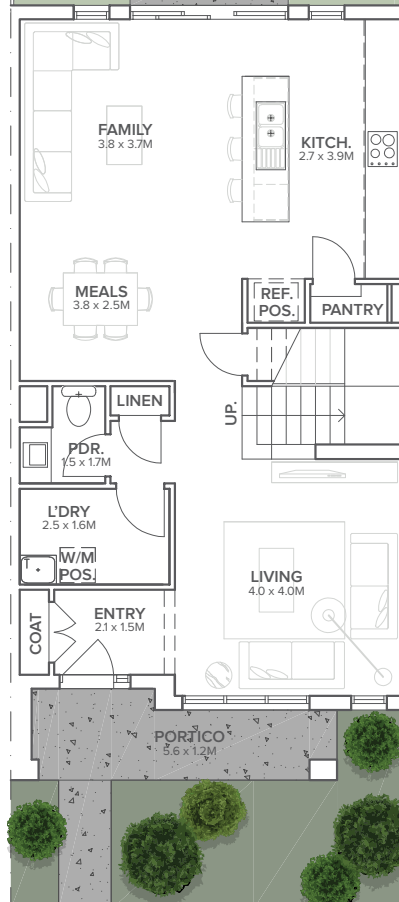

V1 03.2